

Fasen:  $C = (0,1 - 0,2) \times E$   
 minimal 0,2 mm

Radius:  $R = \max. 0,3 \times E$

Lauf:  $t1$  für  $Di \leq 20 \text{ mm} = 60 \mu\text{m}$   
 $t1$  für  $20 \text{ mm} < Di \leq 35 \text{ mm} = 80 \mu\text{m}$   
 $t1$  für  $Di > 35 \text{ mm} = 100 \mu\text{m}$

Einbautoleranz: Gehäuse H8  
 Welle f7



Artikel-Nr.	Artikel-Bezeichnung	Ø Innen	Ø Außen	Länge	Ø Flansch	Länge Flansch
		Di [mm]	Da [mm]	L [mm]	Dfl [mm]	Lfl [mm]
11C003000600040009015	C 3 / 6 x 4 (9 x 1,5) mm	3	6	4	9	1,5
70C003000600050009015	C 3 / 6 x 5 (9 x 1,5) mm	3	6	5	9	1,5
11C003000600060009015	C 3 / 6 x 6 (9 x 1,5) mm	3	6	6	9	1,5
11C003000600100009015	C 3 / 6 x 10 (9 x 1,5) mm	3	6	10	9	1,5
11C004000800040012020	C 4 / 8 x 4 (12 x 2) mm	4	8	4	12	2
70C004000800050012020	C 4 / 8 x 5 (12 x 2) mm	4	8	5	12	2
11C004000800080012020	C 4 / 8 x 8 (12 x 2) mm	4	8	8	12	2
70C004000800100012020	C 4 / 8 x 10 (12 x 2) mm	4	8	10	12	2
11C004000800120012020	C 4 / 8 x 12 (12 x 2) mm	4	8	12	12	2
11C006001000060014020	C 6 / 10 x 6 (14 x 2) mm	6	10	6	14	2
11C006001000100014020	C 6 / 10 x 10 (14 x 2) mm	6	10	10	14	2
70C006001000150014020	C 6 / 10 x 15 (14 x 2) mm	6	10	15	14	2
11C006001000160014020	C 6 / 10 x 16 (14 x 2) mm	6	10	16	14	2
11C008001200080016020	C 8 / 12 x 8 (16 x 2) mm	8	12	8	16	2
70C008001200100016020	C 8 / 12 x 10 (16 x 2) mm	8	12	10	16	2
11C008001200120016020	C 8 / 12 x 12 (16 x 2) mm	8	12	12	16	2
11C008001200160016020	C 8 / 12 x 16 (16 x 2) mm	8	12	16	16	2
11C009001400060019025	C 9 / 14 x 6 (19 x 2,5) mm	9	14	6	19	2,5
11C009001400100019025	C 9 / 14 x 10 (19 x 2,5) mm	9	14	10	19	2,5
11C009001400140019025	C 9 / 14 x 14 (19 x 2,5) mm	9	14	14	19	2,5
11C010001300100016015	C 10 / 13 x 10 (16 x 1,5) mm	10	13	10	16	1,5
11C010001300160016015	C 10 / 13 x 16 (16 x 1,5) mm	10	13	16	16	1,5
11C010001300200016015	C 10 / 13 x 20 (16 x 1,5) mm	10	13	20	16	1,5
70C010001400100018020	C 10 / 14 x 10 (18 x 2) mm	10	14	10	18	2
70C010001400150018020	C 10 / 14 x 15 (18 x 2) mm	10	14	15	18	2
70C010001400200018020	C 10 / 14 x 20 (18 x 2) mm	10	14	20	18	2
11C010001500100020025	C 10 / 15 x 10 (20 x 2,5) mm	10	15	10	20	2,5
11C010001500160020025	C 10 / 15 x 16 (20 x 2,5) mm	10	15	16	20	2,5
11C010001500200020025	C 10 / 15 x 20 (20 x 2,5) mm	10	15	20	20	2,5
70C010001500100020030	C 10 / 15 x 10 (20 x 3) mm	10	15	10	20	3
70C010001500150020030	C 10 / 15 x 15 (20 x 3) mm	10	15	15	20	3
70C010001500160020030	C 10 / 15 x 16 (20 x 3) mm	10	15	16	20	3
70C010001500200020030	C 10 / 15 x 20 (20 x 3) mm	10	15	20	20	3
11C010001600080022030	C 10 / 16 x 8 (22 x 3) mm	10	16	8	22	3
11C010001600100022030	C 10 / 16 x 10 (22 x 3) mm	10	16	10	22	3
11C010001600160022030	C 10 / 16 x 16 (22 x 3) mm	10	16	16	22	3
11C012001500120018015	C 12 / 15 x 12 (18 x 1,5) mm	12	15	12	18	1,5
11C012001500160018015	C 12 / 15 x 16 (18 x 1,5) mm	12	15	16	18	1,5
11C012001500200018015	C 12 / 15 x 20 (18 x 1,5) mm	12	15	20	18	1,5

Artikel-Nr.	Artikel-Bezeichnung	Ø Innen	Ø Außen	Länge	Ø Flansch	Länge Flansch
		Di [mm]	Da [mm]	L [mm]	Dfl [mm]	Lfl [mm]
11C012001700120022025	C 12 / 17 x 12 (22 x 2,5) mm	12	17	12	22	2,5
11C012001700160022025	C 12 / 17 x 16 (22 x 2,5) mm	12	17	16	22	2,5
11C012001700200022025	C 12 / 17 x 20 (22 x 2,5) mm	12	17	20	22	2,5
11C012001700250022025	C 12 / 17 x 25 (22 x 2,5) mm	12	17	25	22	2,5
70C012001700100022030	C 12 / 17 x 10 (22 x 3) mm	12	17	10	22	3
70C012001700120022030	C 12 / 17 x 12 (22 x 3) mm	12	17	12	22	3
70C012001700150022030	C 12 / 17 x 15 (22 x 3) mm	12	17	15	22	3
70C012001700160022030	C 12 / 17 x 16 (22 x 3) mm	12	17	16	22	3
70C012001700200022030	C 12 / 17 x 20 (22 x 3) mm	12	17	20	22	3
70C012001700250022030	C 12 / 17 x 25 (22 x 3) mm	12	17	25	22	3
11C012001800080024030	C 12 / 18 x 8 (24 x 3) mm	12	18	8	24	3
11C012001800120024030	C 12 / 18 x 12 (24 x 3) mm	12	18	12	24	3
11C012001800200024030	C 12 / 18 x 20 (24 x 3) mm	12	18	20	24	3
11C014001800140022020	C 14 / 18 x 14 (22 x 2) mm	14	18	14	22	2
11C014001800180022020	C 14 / 18 x 18 (22 x 2) mm	14	18	18	22	2
11C014001800220022020	C 14 / 18 x 22 (22 x 2) mm	14	18	22	22	2
70C014002000140025030	C 14 / 20 x 14 (25 x 3) mm	14	20	14	25	3
70C014002000150025030	C 14 / 20 x 15 (25 x 3) mm	14	20	15	25	3
70C014002000180025030	C 14 / 20 x 18 (25 x 3) mm	14	20	18	25	3
70C014002000200025030	C 14 / 20 x 20 (25 x 3) mm	14	20	20	25	3
70C014002000220025030	C 14 / 20 x 22 (25 x 3) mm	14	20	22	25	3
70C014002000250025030	C 14 / 20 x 25 (25 x 3) mm	14	20	25	25	3
70C014002000280025030	C 14 / 20 x 28 (25 x 3) mm	14	20	28	25	3
70C014002000300025030	C 14 / 20 x 30 (25 x 3) mm	14	20	30	25	3
11C014002000140026030	C 14 / 20 x 14 (26 x 3) mm	14	20	14	26	3
11C014002000180026030	C 14 / 20 x 18 (26 x 3) mm	14	20	18	26	3
11C014002000220026030	C 14 / 20 x 22 (26 x 3) mm	14	20	22	26	3
11C014002000280026030	C 14 / 20 x 28 (26 x 3) mm	14	20	28	26	3
11C015001900160023020	C 15 / 19 x 16 (23 x 2) mm	15	19	16	23	2
11C015001900200023020	C 15 / 19 x 20 (23 x 2) mm	15	19	20	23	2
11C015001900250023020	C 15 / 19 x 25 (23 x 2) mm	15	19	25	23	2
70C015002000150025030	C 15 / 20 x 15 (25 x 3) mm	15	20	15	25	3
70C015002000200025030	C 15 / 20 x 20 (25 x 3) mm	15	20	20	25	3
70C015002000250025030	C 15 / 20 x 25 (25 x 3) mm	15	20	25	25	3
70C015002000300025030	C 15 / 20 x 30 (25 x 3) mm	15	20	30	25	3
11C015002100160027030	C 15 / 21 x 16 (27 x 3) mm	15	21	16	27	3
11C015002100200027030	C 15 / 21 x 20 (27 x 3) mm	15	21	20	27	3
11C015002100250027030	C 15 / 21 x 25 (27 x 3) mm	15	21	25	27	3
11C015002100320027030	C 15 / 21 x 32 (27 x 3) mm	15	21	32	27	3
11C016002000160024020	C 16 / 20 x 16 (24 x 2) mm	16	20	16	24	2
11C016002000200024020	C 16 / 20 x 20 (24 x 2) mm	16	20	20	24	2
11C016002000250024020	C 16 / 20 x 25 (24 x 2) mm	16	20	25	24	2
70C016002200150028030	C 16 / 22 x 15 (28 x 3) mm	16	22	15	28	3
11C016002200160028030	C 16 / 22 x 16 (28 x 3) mm	16	22	16	28	3
11C016002200200028030	C 16 / 22 x 20 (28 x 3) mm	16	22	20	28	3
11C016002200250028030	C 16 / 22 x 25 (28 x 3) mm	16	22	25	28	3
70C016002200300028030	C 16 / 22 x 30 (28 x 3) mm	16	22	30	28	3
11C016002200320028030	C 16 / 22 x 32 (28 x 3) mm	16	22	32	28	3
11C018002200180026020	C 18 / 22 x 18 (26 x 2) mm	18	22	18	26	2
11C018002200220026020	C 18 / 22 x 22 (26 x 2) mm	18	22	22	26	2
11C018002200280026020	C 18 / 22 x 28 (26 x 2) mm	18	22	28	26	2

Artikel-Nr.	Artikel-Bezeichnung	Ø Innen	Ø Außen	Länge	Ø Flansch	Länge Flansch
		Di [mm]	Da [mm]	L [mm]	Dfl [mm]	Lfl [mm]
11C018002400180030030	C 18 / 24 x 18 (30 x 3) mm	18	24	18	30	3
11C018002400220030030	C 18 / 24 x 22 (30 x 3) mm	18	24	22	30	3
11C018002400280030030	C 18 / 24 x 28 (30 x 3) mm	18	24	28	30	3
70C018002500200032040	C 18 / 25 x 20 (32 x 4) mm	18	25	20	32	4
70C018002500250032040	C 18 / 25 x 25 (32 x 4) mm	18	25	25	32	4
70C018002500300032040	C 18 / 25 x 30 (32 x 4) mm	18	25	30	32	4
70C018002500350032040	C 18 / 25 x 35 (32 x 4) mm	18	25	35	32	4
70C020002400100028020	C 20 / 24 x 10 (28 x 2) mm	20	24	10	28	2
11C020002400160028020	C 20 / 24 x 16 (28 x 2) mm	20	24	16	28	2
11C020002400200028020	C 20 / 24 x 20 (28 x 2) mm	20	24	20	28	2
11C020002400250028020	C 20 / 24 x 25 (28 x 2) mm	20	24	25	28	2
70C020002600150032030	C 20 / 26 x 15 (32 x 3) mm	20	26	15	32	3
11C020002600160032030	C 20 / 26 x 16 (32 x 3) mm	20	26	16	32	3
11C020002600200032030	C 20 / 26 x 20 (32 x 3) mm	20	26	20	32	3
11C020002600250032030	C 20 / 26 x 25 (32 x 3) mm	20	26	25	32	3
70C020002600300032030	C 20 / 26 x 30 (32 x 3) mm	20	26	30	32	3
11C020002600320032030	C 20 / 26 x 32 (32 x 3) mm	20	26	32	32	3
70C020002800200035040	C 20 / 28 x 20 (35 x 4) mm	20	28	20	35	4
70C020002800250035040	C 20 / 28 x 25 (35 x 4) mm	20	28	25	35	4
70C020002800350035040	C 20 / 28 x 35 (35 x 4) mm	20	28	35	35	4
11C022002700180032025	C 22 / 27 x 18 (32 x 2,5) mm	22	27	18	32	2,5
11C022002700220032025	C 22 / 27 x 22 (32 x 2,5) mm	22	27	22	32	2,5
11C022002700280032025	C 22 / 27 x 28 (32 x 2,5) mm	22	27	28	32	2,5
70C022002800150033040	C 22 / 28 x 15 (33 x 4) mm	22	28	15	33	4
70C022002800200033040	C 22 / 28 x 20 (33 x 4) mm	22	28	20	33	4
70C022002800250033040	C 22 / 28 x 25 (33 x 4) mm	22	28	25	33	4
70C022002800350033040	C 22 / 28 x 35 (33 x 4) mm	22	28	35	33	4
70C022002800400033040	C 22 / 28 x 40 (33 x 4) mm	22	28	40	33	4
11C022002800150034030	C 22 / 28 x 15 (34 x 3) mm	22	28	15	34	3
11C022002800200034030	C 22 / 28 x 20 (34 x 3) mm	22	28	20	34	3
11C022002800250034030	C 22 / 28 x 25 (34 x 3) mm	22	28	25	34	3
11C022002800300034030	C 22 / 28 x 30 (34 x 3) mm	22	28	30	34	3
11C022002900180036035	C 22 / 29 x 18 (36 x 3,5) mm	22	29	18	36	3,5
11C022002900220036035	C 22 / 29 x 22 (36 x 3,5) mm	22	29	22	36	3,5
11C022002900280036035	C 22 / 29 x 28 (36 x 3,5) mm	22	29	28	36	3,5
11C022002900360036035	C 22 / 29 x 36 (36 x 3,5) mm	22	29	36	36	3,5
11C025003000200035025	C 25 / 30 x 20 (35 x 2,5) mm	25	30	20	35	2,5
11C025003000250035025	C 25 / 30 x 25 (35 x 2,5) mm	25	30	25	35	2,5
11C025003000320035025	C 25 / 30 x 32 (35 x 2,5) mm	25	30	32	35	2,5
11C025003200200039035	C 25 / 32 x 20 (39 x 3,5) mm	25	32	20	39	3,5
11C025003200250039035	C 25 / 32 x 25 (39 x 3,5) mm	25	32	25	39	3,5
11C025003200320039035	C 25 / 32 x 32 (39 x 3,5) mm	25	32	32	39	3,5
70C025003200200040040	C 25 / 32 x 20 (40 x 4) mm	25	32	20	40	4
70C025003200250040040	C 25 / 32 x 25 (40 x 4) mm	25	32	25	40	4
70C025003200300040040	C 25 / 32 x 30 (40 x 4) mm	25	32	30	40	4
70C025003200350040040	C 25 / 32 x 35 (40 x 4) mm	25	32	35	40	4
70C025003200400040040	C 25 / 32 x 40 (40 x 4) mm	25	32	40	40	4
70C025003500160045050	C 25 / 35 x 16 (45 x 5) mm	25	35	16	45	5
70C025003500250045050	C 25 / 35 x 25 (45 x 5) mm	25	35	25	45	5
70C025003500300045050	C 25 / 35 x 30 (45 x 5) mm	25	35	30	45	5
11C028003300220038025	C 28 / 33 x 22 (38 x 2,5) mm	28	33	22	38	2,5

Artikel-Nr.	Artikel-Bezeichnung	Ø Innen	Ø Außen	Länge	Ø Flansch	Länge Flansch
		Di [mm]	Da [mm]	L [mm]	Dfl [mm]	Lfl [mm]
11C028003300280038025	C 28 / 33 x 28 (38 x 2,5) mm	28	33	28	38	2,5
11C028003300360038025	C 28 / 33 x 36 (38 x 2,5) mm	28	33	36	38	2,5
11C028003600220044040	C 28 / 36 x 22 (44 x 4) mm	28	36	22	44	4
70C028003600250044040	C 28 / 36 x 25 (44 x 4) mm	28	36	25	44	4
11C028003600280044040	C 28 / 36 x 28 (44 x 4) mm	28	36	28	44	4
70C028003600300044040	C 28 / 36 x 30 (44 x 4) mm	28	36	30	44	4
70C028003600350044040	C 28 / 36 x 35 (44 x 4) mm	28	36	35	44	4
11C028003600360044040	C 28 / 36 x 36 (44 x 4) mm	28	36	36	44	4
70C028003600400044040	C 28 / 36 x 40 (44 x 4) mm	28	36	40	44	4
11C030003800200046040	C 30 / 38 x 20 (46 x 4) mm	30	38	20	46	4
11C030003800250046040	C 30 / 38 x 25 (46 x 4) mm	30	38	25	46	4
11C030003800300046040	C 30 / 38 x 30 (46 x 4) mm	30	38	30	46	4
70C030004000250048040	C 30 / 40 x 25 (48 x 4) mm	30	40	25	48	4
70C030004000300048040	C 30 / 40 x 30 (48 x 4) mm	30	40	30	48	4
70C030004000350048040	C 30 / 40 x 35 (48 x 4) mm	30	40	35	48	4
70C030004000400048040	C 30 / 40 x 40 (48 x 4) mm	30	40	40	48	4
11C032003800200044030	C 32 / 38 x 20 (44 x 3) mm	32	38	20	44	3
11C032003800250044030	C 32 / 38 x 25 (44 x 3) mm	32	38	25	44	3
11C032003800320044030	C 32 / 38 x 32 (44 x 3) mm	32	38	32	44	3
11C032004000200048040	C 32 / 40 x 20 (48 x 4) mm	32	40	20	48	4
11C032004000250048040	C 32 / 40 x 25 (48 x 4) mm	32	40	25	48	4
11C032004000300048040	C 32 / 40 x 30 (48 x 4) mm	32	40	30	48	4
11C032004000320048040	C 32 / 40 x 32 (48 x 4) mm	32	40	32	48	4
70C032004000350048040	C 32 / 40 x 35 (48 x 4) mm	32	40	35	48	4
70C032004000400048040	C 32 / 40 x 40 (48 x 4) mm	32	40	40	48	4
70C035004200160045040	C 35 / 42 x 16 (45 x 4) mm	35	42	16	45	4
70C035004500200055050	C 35 / 45 x 20 (55 x 5) mm	35	45	20	55	5
70C035004500250055050	C 35 / 45 x 25 (55 x 5) mm	35	45	25	55	5
70C035004500300055050	C 35 / 45 x 30 (55 x 5) mm	35	45	30	55	5
70C035004500350055050	C 35 / 45 x 35 (55 x 5) mm	35	45	35	55	5
70C035004500400055050	C 35 / 45 x 40 (55 x 5) mm	35	45	40	55	5
11C036004200220048030	C 36 / 42 x 22 (48 x 3) mm	36	42	22	48	3
11C036004200280048030	C 36 / 42 x 28 (48 x 3) mm	36	42	28	48	3
11C036004200360048030	C 36 / 42 x 36 (48 x 3) mm	36	42	36	48	3
11C036004500220054045	C 36 / 45 x 22 (54 x 4,5) mm	36	45	22	54	4,5
11C036004500280054045	C 36 / 45 x 28 (54 x 4,5) mm	36	45	28	54	4,5
11C036004500360054045	C 36 / 45 x 36 (54 x 4,5) mm	36	45	36	54	4,5
11C040004600250052030	C 40 / 46 x 25 (52 x 3) mm	40	46	25	52	3
11C040004600320052030	C 40 / 46 x 32 (52 x 3) mm	40	46	32	52	3
11C040004600400052030	C 40 / 46 x 40 (52 x 3) mm	40	46	40	52	3
11C040005000250060050	C 40 / 50 x 25 (60 x 5) mm	40	50	25	60	5
70C040005000300060050	C 40 / 50 x 30 (60 x 5) mm	40	50	30	60	5
11C040005000320060050	C 40 / 50 x 32 (60 x 5) mm	40	50	32	60	5
70C040005000350060050	C 40 / 50 x 35 (60 x 5) mm	40	50	35	60	5
11C040005000400060050	C 40 / 50 x 40 (60 x 5) mm	40	50	40	60	5
11C045005100280057030	C 45 / 51 x 28 (57 x 3) mm	45	51	28	57	3
11C045005100360057030	C 45 / 51 x 36 (57 x 3) mm	45	51	36	57	3
11C045005100450057030	C 45 / 51 x 45 (57 x 3) mm	45	51	45	57	3
11C045005600280067055	C 45 / 56 x 28 (67 x 5,5) mm	45	56	28	67	5,5
11C045005600360067055	C 45 / 56 x 36 (67 x 5,5) mm	45	56	36	67	5,5
11C045005600450067055	C 45 / 56 x 45 (67 x 5,5) mm	45	56	45	67	5,5

Artikel-Nr.	Artikel-Bezeichnung	Ø Innen	Ø Außen	Länge	Ø Flansch	Länge Flansch
		Di [mm]	Da [mm]	L [mm]	Dfl [mm]	Lfl [mm]
17C050006000300070060	C 50 / 60 x 30 (70 x 6) mm	50	60	30	70	6
17C050006000500070060	C 50 / 60 x 50 (70 x 6) mm	50	60	50	70	6
17C060007200500084060	C 60 / 72 x 50 (84 x 6) mm	60	72	50	84	6
17C060007200600084060	C 60 / 72 x 60 (84 x 6) mm	60	72	60	84	6
17C060007500350085080	C 60 / 75 x 35 (85 x 8) mm	60	75	35	85	8
17C060007500600085080	C 60 / 75 x 60 (85 x 8) mm	60	75	60	85	8
17C070008500600095080	C 70 / 85 x 60 (95 x 8) mm	70	85	60	95	8
17C080009500700105080	C 80 / 95 x 70 (105 x 8) mm	80	95	70	105	8
17C090011000500120080	C 90 / 110 x 50 (120 x 8) mm	90	110	50	120	8
17C100012000800130080	C 100 / 120 x 80 (130 x 8) mm	100	120	80	130	8

# Sinter-Flanschbuchsen BRONZE SINT A51

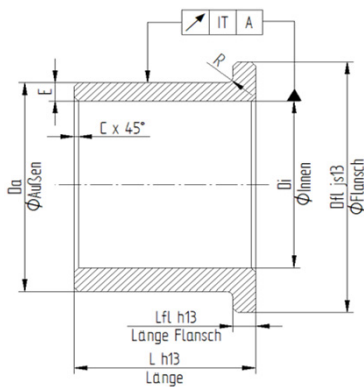

Fasen:  $C = (0,1 - 0,2) \times E$   
minimal 0,2 mm

Radius:  $R = \max. 0,3 \times E$

Lauf:  $Da < 50 \text{ mm}$  IT9  
 $Da > 50 \text{ mm}$  IT10

Einbautoleranz:  $Da < 50 \text{ mm}$  Gehäuse F7  
Welle h7  
 $Da < 50 \text{ mm}$  Gehäuse F8  
Welle h7



Artikel-Nr.	Artikel-Bezeichnung	Ø Innen	Ø Außen	Länge	Ø Flansch	Länge Flansch
		Di [mm]	Da [mm]	L [mm]	Dfl [mm]	Lfl [mm]
17C003000500040008015	C 3 / 5 x 4 (8 x 1,5) mm	3	5	4	8	1,5
17C003000500040009015	C 3 / 6 x 4 (9 x 1,5) mm	3	6	4	9	1,5
17C003000600060009015	C 3 / 6 x 6 (9 x 1,5) mm	3	6	6	9	1,5
17C003000600100009015	C 3 / 6 x 10 (9 x 1,5) mm	3	6	10	9	1,5
17C004000800060010015	C 4 / 8 x 6 (10 x 1,5) mm	4	8	6	10	1,5
17C004000800040012020	C 4 / 8 x 4 (12 x 2) mm	4	8	4	12	2
17C004000800060012020	C 4 / 8 x 6 (12 x 2) mm	4	8	6	12	2
17C005000900040013020	C 5 / 9 x 4 (13 x 2) mm	5	9	4	13	2
17C005000900050013020	C 5 / 9 x 5 (13 x 2) mm	5	9	5	13	2
17C005000900080013020	C 5 / 9 x 8 (13 x 2) mm	5	9	8	13	2
17C005001000060012020	C 5 / 10 x 6 (12 x 2) mm	5	10	6	12	2
17C006001000040014020	C 6 / 10 x 4 (14 x 2) mm	6	10	4	14	2
17C006001000060014020	C 6 / 10 x 6 (14 x 2) mm	6	10	6	14	2
17C006001000100014020	C 6 / 10 x 10 (14 x 2) mm	6	10	10	14	2
17C006001200060014020	C 6 / 12 x 6 (14 x 2) mm	6	12	6	14	2
17C008001200050016020	C 8 / 12 x 5 (16 x 2) mm	8	12	5	16	2
17C008001200060016020	C 8 / 12 x 6 (16 x 2) mm	8	12	6	16	2
17C008001200080016020	C 8 / 12 x 8 (16 x 2) mm	8	12	8	16	2
17C008001200100016020	C 8 / 12 x 10 (16 x 2) mm	8	12	10	16	2
17C008001200120016020	C 8 / 12 x 12 (16 x 2) mm	8	12	12	16	2
17C008001400080018030	C 8 / 14 x 8 (18 x 3) mm	8	14	8	18	3
17C010001300100016015	C 10 / 13 x 10 (16 x 1,5) mm	10	13	10	16	1,5
17C010001300160016015	C 10 / 13 x 16 (16 x 1,5) mm	10	13	16	16	1,5
17C010001300200016015	C 10 / 13 x 20 (16 x 1,5) mm	10	13	20	16	1,5
17C010001600080020030	C 10 / 16 x 8 (20 x 3) mm	10	16	8	20	3
17C010001600100020030	C 10 / 16 x 10 (20 x 3) mm	10	16	10	20	3
17C010001600080022030	C 10 / 16 x 8 (22 x 3) mm	10	16	8	22	3
17C010001600100022030	C 10 / 16 x 10 (22 x 3) mm	10	16	10	22	3
17C010001600160022030	C 10 / 16 x 16 (22 x 3) mm	10	16	16	22	3
17C012001800100022030	C 12 / 18 x 10 (22 x 3) mm	12	18	10	22	3
17C012001800120022030	C 12 / 18 x 12 (22 x 3) mm	12	18	12	22	3
17C012001800080024030	C 12 / 18 x 8 (24 x 3) mm	12	18	8	24	3
17C012001800120024030	C 12 / 18 x 12 (24 x 3) mm	12	18	12	24	3
17C012001800200024030	C 12 / 18 x 20 (24 x 3) mm	12	18	20	24	3
17C014002000100025030	C 14 / 20 x 10 (25 x 3) mm	14	20	10	25	3
17C014002000120025030	C 14 / 20 x 12 (25 x 3) mm	14	20	12	25	3
17C014002000100026030	C 14 / 20 x 10 (26 x 3) mm	14	20	10	26	3
17C014002000140026030	C 14 / 20 x 14 (26 x 3) mm	14	20	14	26	3
17C014002000200026030	C 14 / 20 x 20 (26 x 3) mm	14	20	20	26	3

Artikel-Nr.	Artikel-Bezeichnung	Ø Innen	Ø Außen	Länge	Ø Flansch	Länge Flansch
		Di [mm]	Da [mm]	L [mm]	Dfl [mm]	Lfl [mm]
17C015002000150027030	C 15 / 20 x 15 (27 x 3) mm	15	20	15	27	3
17C015002000250027030	C 15 / 20 x 25 (27 x 3) mm	15	20	25	27	3
17C015002100100027030	C 15 / 21 x 10 (27 x 3) mm	15	21	10	27	3
17C015002100150027030	C 15 / 21 x 15 (27 x 3) mm	15	21	15	27	3
17C015002100250027030	C 15 / 21 x 25 (27 x 3) mm	15	21	25	27	3
17C015002200120028030	C 15 / 22 x 12 (28 x 3) mm	15	22	12	28	3
17C015002200160028030	C 15 / 22 x 16 (28 x 3) mm	15	22	16	28	3
17C016002200120028030	C 16 / 22 x 12 (28 x 3) mm	16	22	12	28	3
17C016002200160028030	C 16 / 22 x 16 (28 x 3) mm	16	22	16	28	3
17C016002200250028030	C 16 / 22 x 25 (28 x 3) mm	16	22	25	28	3
17C016002200120028040	C 16 / 22 x 12 (28 x 4) mm	16	22	12	28	4
17C016002200160028040	C 16 / 22 x 16 (28 x 4) mm	16	22	16	28	4
17C018002400120030030	C 18 / 24 x 12 (30 x 3) mm	18	24	12	30	3
17C018002400180030030	C 18 / 24 x 18 (30 x 3) mm	18	24	18	30	3
17C018002400300030030	C 18 / 24 x 30 (30 x 3) mm	18	24	30	30	3
17C018002500120032040	C 18 / 25 x 12 (32 x 4) mm	18	25	12	32	4
17C018002500160032040	C 18 / 25 x 16 (32 x 4) mm	18	25	16	32	4
17C020002600150032030	C 20 / 26 x 15 (32 x 3) mm	20	26	15	32	3
17C020002600200032030	C 20 / 26 x 20 (32 x 3) mm	20	26	20	32	3
17C020002600250032030	C 20 / 26 x 25 (32 x 3) mm	20	26	25	32	3
17C020002600300032030	C 20 / 26 x 30 (32 x 3) mm	20	26	30	32	3
17C020002800160035040	C 20 / 28 x 16 (35 x 4) mm	20	28	16	35	4
17C020002800200035040	C 20 / 28 x 20 (35 x 4) mm	20	28	20	35	4
17C025003200200039035	C 25 / 32 x 20 (39 x 3,5) mm	25	32	20	39	3,5
17C025003200250039035	C 25 / 32 x 25 (39 x 3,5) mm	25	32	25	39	3,5
17C025003200300039035	C 25 / 32 x 30 (39 x 3,5) mm	25	32	30	39	3,5
17C025003500160045050	C 25 / 35 x 16 (45 x 5) mm	25	35	16	45	5
17C025003500250045050	C 25 / 35 x 25 (45 x 5) mm	25	35	25	45	5
17C030003800200046040	C 30 / 38 x 20 (46 x 4) mm	30	38	20	46	4
17C030003800250046040	C 30 / 38 x 25 (46 x 4) mm	30	38	25	46	4
17C030003800300046040	C 30 / 38 x 30 (46 x 4) mm	30	38	30	46	4
17C030004000200050050	C 30 / 40 x 20 (50 x 5) mm	30	40	20	50	5
17C030004000300050050	C 30 / 40 x 30 (50 x 5) mm	30	40	30	50	5
17C035004500200055050	C 35 / 45 x 20 (55 x 5) mm	35	45	20	55	5
17C035004500250055050	C 35 / 45 x 25 (55 x 5) mm	35	45	25	55	5
17C035004500350055050	C 35 / 45 x 35 (55 x 5) mm	35	45	35	55	5
17C035004500400055050	C 35 / 45 x 40 (55 x 5) mm	35	45	40	55	5
17C038004800350060050	C 38 / 48 x 35 (60 x 5) mm	38	48	35	60	5
17C040005000250060050	C 40 / 50 x 25 (60 x 5) mm	40	50	25	60	5
17C040005000300060050	C 40 / 50 x 30 (60 x 5) mm	40	50	30	60	5
17C040005000400060050	C 40 / 50 x 40 (60 x 5) mm	40	50	40	60	5
17C040005000500060050	C 40 / 50 x 50 (60 x 5) mm	40	50	50	60	5
17C040005000250060060	C 40 / 50 x 25 (60 x 6) mm	40	50	25	60	6
17C040005000400060060	C 40 / 50 x 40 (60 x 6) mm	40	50	40	60	6
17C045005500350065050	C 45 / 55 x 35 (65 x 5) mm	45	55	35	65	5
17C045005500450065050	C 45 / 55 x 45 (65 x 5) mm	45	55	45	65	5
17C045005500550065050	C 45 / 55 x 55 (65 x 5) mm	45	55	55	65	5
17C045005500300065060	C 45 / 55 x 30 (65 x 6) mm	45	55	30	65	6
17C045005500450065060	C 45 / 55 x 45 (65 x 6) mm	45	55	45	65	6
17C050006000350070050	C 50 / 60 x 35 (70 x 5) mm	50	60	35	70	5
17C050006000500070050	C 50 / 60 x 50 (70 x 5) mm	50	60	50	70	5

Artikel-Nr.	Artikel-Bezeichnung	Ø Innen	Ø Außen	Länge	Ø Flansch	Länge Flansch
		Di [mm]	Da [mm]	L [mm]	Dfl [mm]	Lfl [mm]
11C050005600320062030	C 50 / 56 x 32 (62 x 3) mm	50	56	32	62	3
11C050005600400062030	C 50 / 56 x 40 (62 x 3) mm	50	56	40	62	3
11C050005600500062030	C 50 / 56 x 50 (62 x 3) mm	50	56	50	62	3
11C050006000320070050	C 50 / 60 x 32 (70 x 5) mm	50	60	32	70	5
11C050006000400070050	C 50 / 60 x 40 (70 x 5) mm	50	60	40	70	5
11C050006000500070050	C 50 / 60 x 50 (70 x 5) mm	50	60	50	70	5
11C060007000500080050	C 60 / 70 x 50 (80 x 5) mm	60	70	50	80	5
11C060007000600080050	C 60 / 70 x 60 (80 x 5) mm	60	70	60	80	5



Sinter-Flanschbuchsen BRONZE  
SINT B50 (DIN 1850) G7 / r7

helgerit

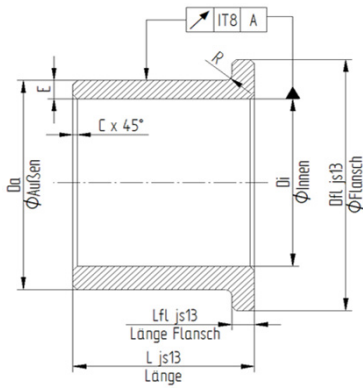

Artikel-Nr.	Artikel-Bezeichnung	Ø Innen	Ø Außen	Länge	Ø Flansch	Länge Flansch
		Di [mm]	Da [mm]	L [mm]	Dfl [mm]	Lfl [mm]
80C004000800060010020	C 4 / 8 x 6 (10 x 2) mm	4	8	6	10	2
80C006001000100012020	C 6 / 10 x 10 (12 x 2) mm	6	10	10	12	2
80C008001200150014020	C 8 / 12 x 15 (14 x 2) mm	8	12	15	14	2
80C010001600200020020	C 10 / 16 x 20 (20 x 2) mm	10	16	20	20	2
80C012001600200018020	C 12 / 16 x 20 (18 x 2) mm	12	16	20	18	2
80C014002000250023030	C 14 / 20 x 25 (23 x 3) mm	14	20	25	23	3
80C016002200200028030	C 16 / 22 x 20 (28 x 3) mm	16	22	20	28	3
80C018002400300032030	C 18 / 24 x 30 (32 x 3) mm	18	24	30	32	3
80C020002600300032030	C 20 / 26 x 30 (32 x 3) mm	20	26	30	32	3